



Switching, Sensing and Control Solutions

from GENTECH INTERNATIONAL LTD

Grangestone Industrial Estate, Girvan, Ayrshire KA26 9PS, United Kingdom

Telephone: +44 (0) 1465-713581. Fax: +44 (0) 1465 714974

Email: sales@gentech-international.co.uk

Website: gentech-international.co.uk

PSS SERIES POSITION SENSOR

DESIGN FEATURES

- *Adaptable design*
- *Reed switch fully encapsulated to IP65*
- *Flying lead or fast-on termination*
- *Nylon 6.6 construction*
- *Shunt operation*

The Gentech PSS U-shaped magnetic reed switch sensor features fixed poles for easy set-up and adjustment in a variety of applications. The sensor operates when a piece of metal is introduced between the forks of the sensor, interrupting the field to close or open the switch.



Operational Characteristics

Switch Option		01
Contact Configuration		SPST
Contact ratings		
Maximum (resistive loads)	Volts DC	500
	Amps	1.0
	Watts	15
Minimum withstand across open contacts	Volts	800
Initial contact resistance	Ohms	0.5

The above contact ratings are for resistive loads. For inductive, capacitive and tungsten filament lamp loads refer to the circuit protection notebook.

TYPICAL APPLICATIONS

- *Door interrupt systems*
- *Open/interlock machinery lid indication*
- *Rotational counting*

Electrical Connections

Fast-on terminals or 0.5 metre of 2 core round 16/0.2mm cable

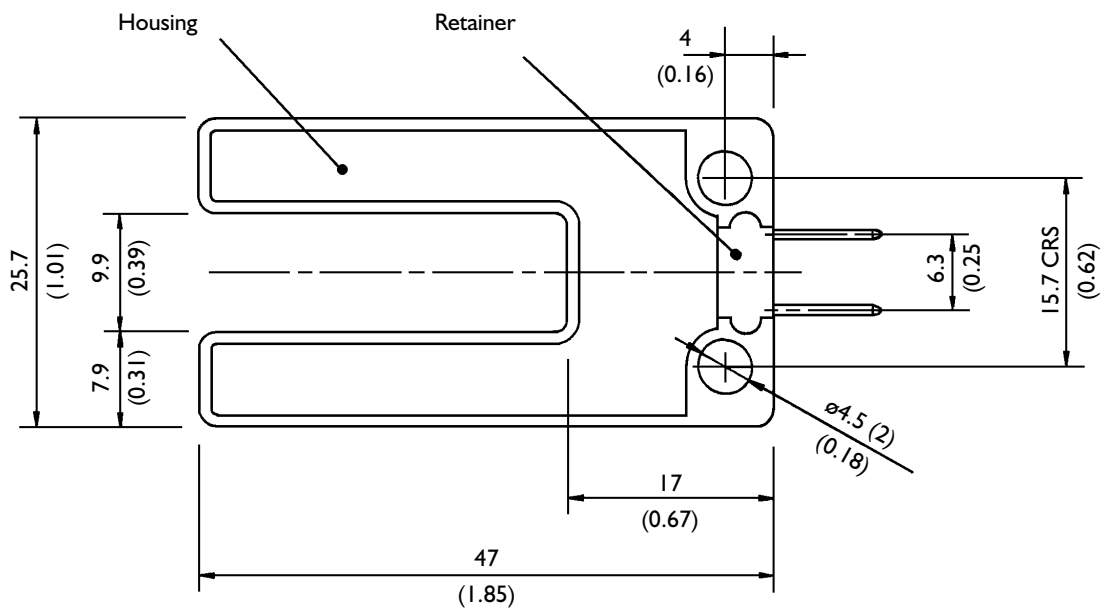
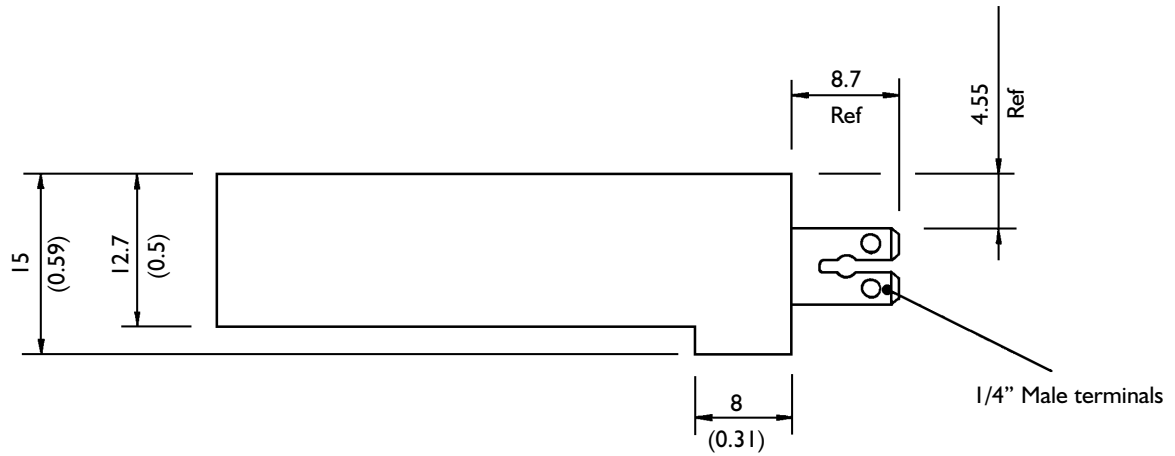

NOTE: Flying lead termination also available

Installation

Please contact Sales at Gentech for installation instructions (Ref. FI 1000-R1)

Applications

Please contact Sales at Gentech for applications relating to this product group.



GENTECH INTERNATIONAL LTD
 Grangestone Industrial Estate, Girvan, Ayrshire KA26 9PS, United Kingdom
 Telephone: +44 (0) 1465-713581. Fax: +44 (0) 1465 714974
 Email: sales@gentech-international.co.uk
 Website: gentech-international.co.uk