

PRODUCT DATA SHEET

Movement Sensor - Non Mercury

VBS 030100

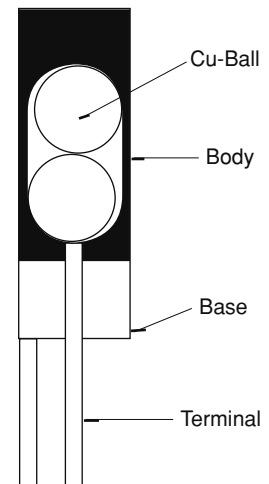
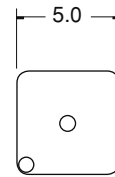
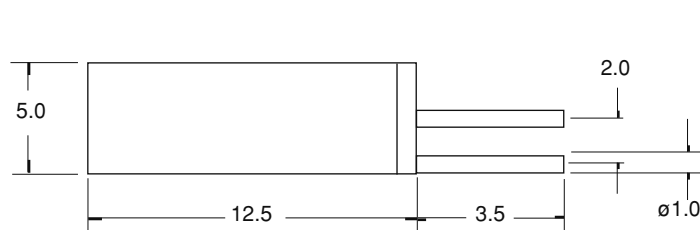

Drawings not to scale
All dimensions in mm nominal

SPECIFICATION

CONTACT FORM / STYLE		Normally Closed
CONTACT RATING	Max. mA	25mA at 24Vdc
OPERATING TEMPERATURE	Deg. °C	-25° +70°
STORAGE TEMPERATURE	Deg. °C	-40° +85°
CASE MATERIAL		Zinc Alloy
FINISH		Tin-plated over nickel
TERMINATION		Gold plated over nickel
SOLDERABILITY		230 max for 5 secs
OPERATE LIFE		1,000,000 cycles

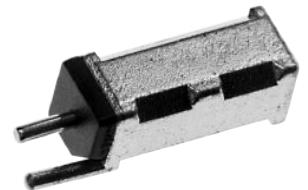

Switch with two contact balls for extra sensitivity to detect vibration.
Ideal for anti-tamper detection in security systems.
Switch will operate in all positions although sensitivity may vary.
Circuit is normally closed but switch should be used in a change of state mode.

Rev. No.	Revision Note	Date
C	Web Site 2004	17-3-04

As part of the company policy of continued product improvement, specifications may change without notice. Our sales office will be pleased to help you with the latest information on this product range and details of our full design and manufacturing service. All products are supplied to our standard conditions of sale otherwise agreed in writing.

ACTIVE
SWITCH & SENSOR

©2004
Active Switch & Sensor Limited